

# HIGH END SYSTEM WINDOWS AND DOORS



 LANJIA WINDOW AND DOOR

# Casement Door



Brand honor

Honor  
certification

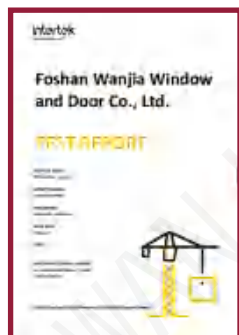



**WANJIA**  
WINDOW & DOOR





# CASEMENT DOORS SERIES

The door frame and door leaf are all spliced at a 45-degree angle, with glue-injected corner code connectors, the connection is firmer and the structure is more stable. The structure of the middle seal is adopted, and the glass is divided into two parts, the drainage cavity and the sealed cavity, to prevent the hidden danger of poor sealing at the sealing position.

---

## 35.3

Standard heat insulation strip

---

## 1.8mm

German craft profile

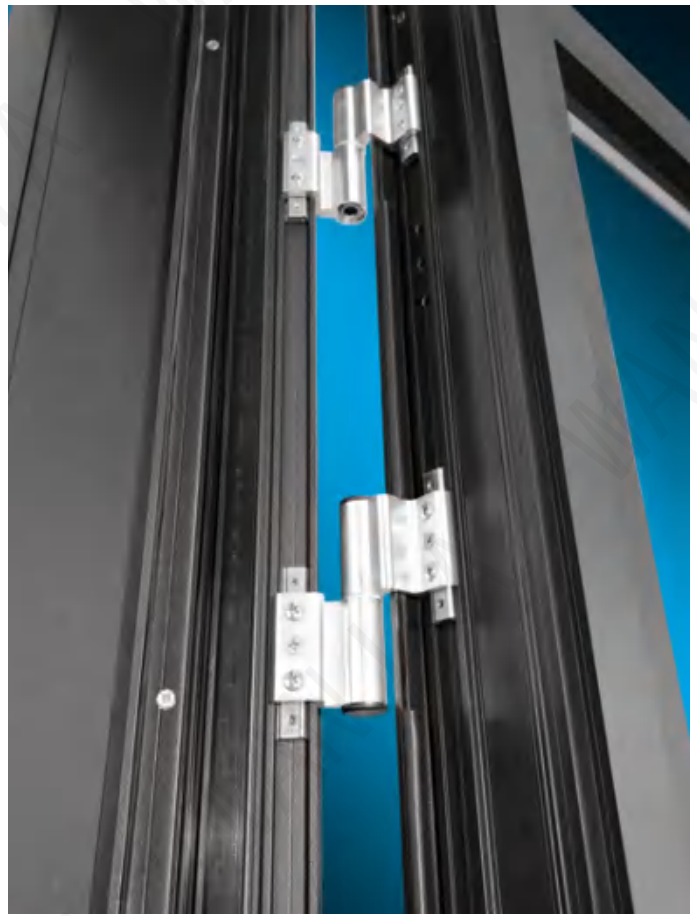

## PRODUCT DETAILS



# 50 SERIES ALUMINUM CASEMENT DOOR

## Profile thickness:

sash thickness: 1.4mm

door thickness: 1.8mm

Frame thickness: 1.4mm

## Tilt and turn window:

Fan width: 520mm–800mm

Fan height: 700mm–1500mm

Maximum fan load: 60kg

## Casement window:

Fan width: 400mm–800mm

Fan height: 700mm–1500mm

Maximum fan load: 60kg

## When the 50 series is used for casement doors:

Width: 600mm–900mm

Height: 1800mm–2400mm

**Glass:** 5mm+6A+5mm double tempered glass

In the case of broken edges, it can make up to 5mm+19A+5mm double tempered insulating glass

## Grills:

normal is falt grill (6A or 9A hollow) or square large grill (19A hollow)

**Blinds:** magnetic control Blinds

The corner angle can be 90° and 135°

## Basic parameters:



Thermal insulation coefficient:  
**Uw4.0W/ m² K**



Wind pressure resistance  
**2000Pa**



Water tightness:  
**300Pa**



Air tightness:  
**Class 3**



Sound insulation performance:  
**25dB**

## Product description:

- 1.The wall thickness of the standard profile is 1.4mm, and the design adopts the European standard notch to meet the versatility of accessories on the marketEasy to use, flexible, more space-saving, large opening area, wide field of vision, and more conducive to air convection.
- 2.The door leaf is beautifully designed and suitable for high-end villas, residences and clubs.
- 3.The opening style can be done: outside opening window, inside opening window, Tilt and turn window, top hung window;,single casement door, double casement door.

# HARDWARE CONFIGURATION



—— Wind bracing ——



—— Lock cylinder ——



—— Drive rod - lock seat - lock point - connector ——



—— Transmission box ——



—— Lock cylinder cover ——



—— Hinge ——

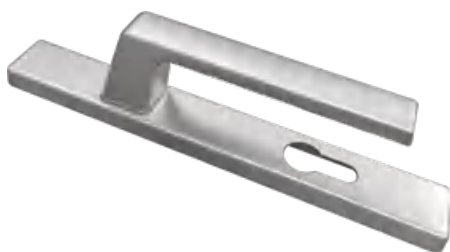

—— Handle ——



—— Handle ——

# 50 SERIES ALUMINUM CASEMENT DOOR

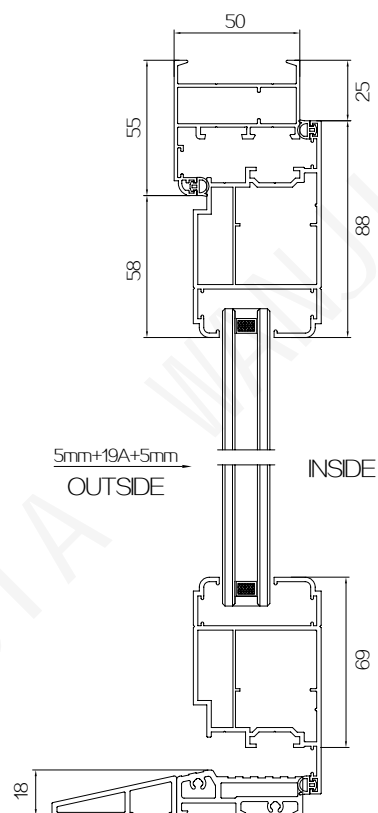
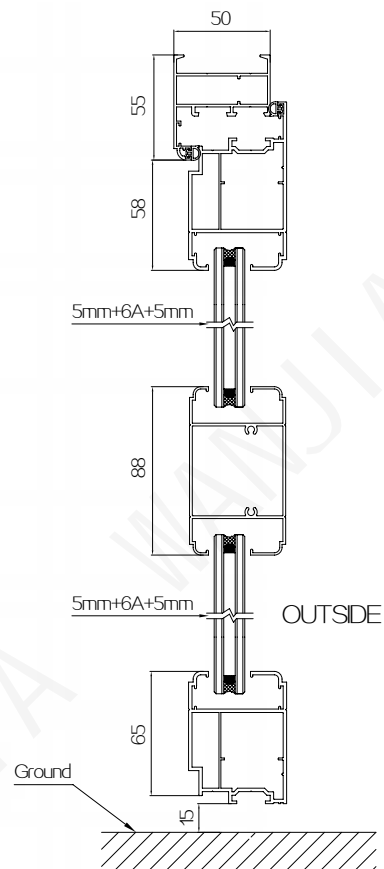



---

## 18 SERIES

### NARROW FRAME ALUMINUM CASEMENT DOOR

---

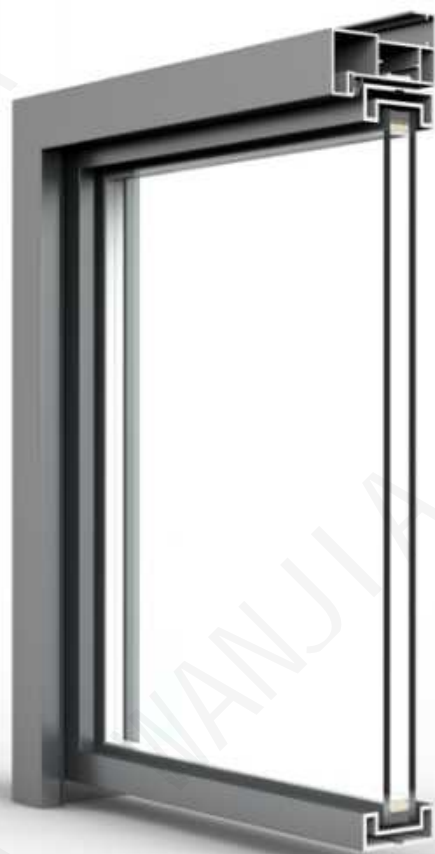

#### Processing dimensions of windows and doors:

Width : 817mm    Height : 1925mm

---

**Glass:** 5mm frosted glass + 15A + 5mm Changhong glass

The glass frosting surface is on the indoor surface; Changhong glass is outside the room.

The concave convex surface of Changhong glass is made in the hollow layer.

---

**Package:** Double clad mode, wall thickness 190mm.

---

**Remarks:** door gap distance 10mm (between the bottom frame and the ground)

# 18 SERIES NARROW FRAME ALUMINUM CASEMENT DOOR

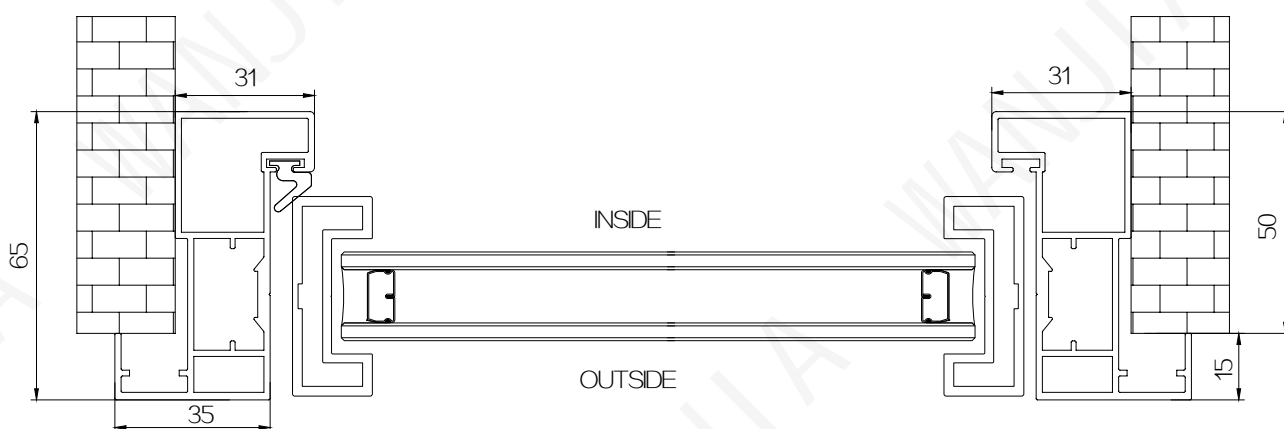
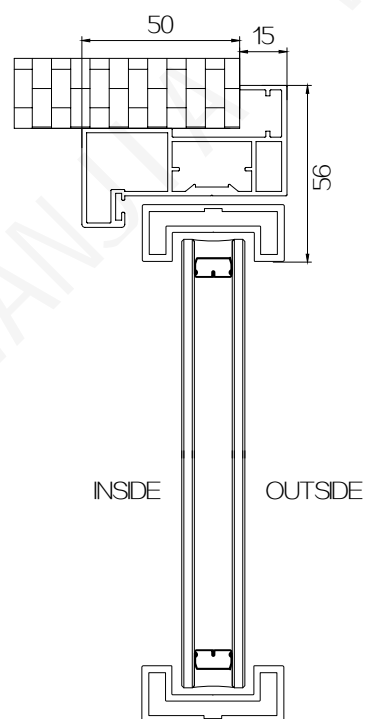
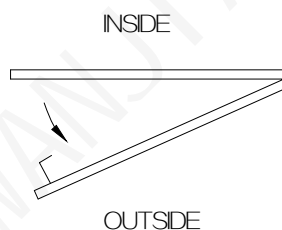
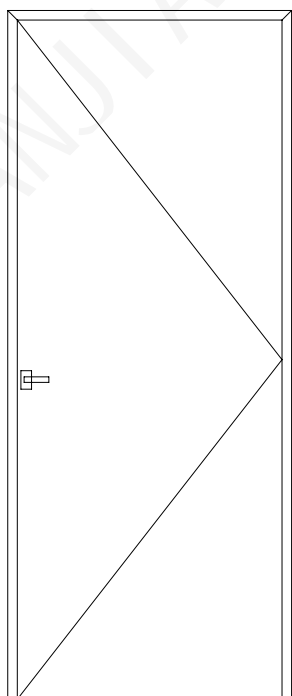

# 18 SERIES

## NARROW FRAME ALUMINUM CASEMENT DOOR

Double jacket

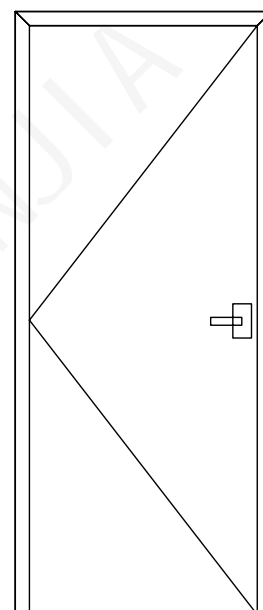
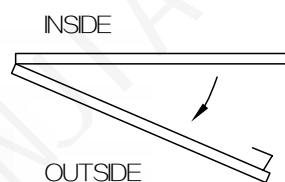

Remarks: It's 10mm between the bottom frame and the ground

